

CERTIFIED RECORD OF LAND CORNER MONUMENTATION

History of original corner establishment:

None

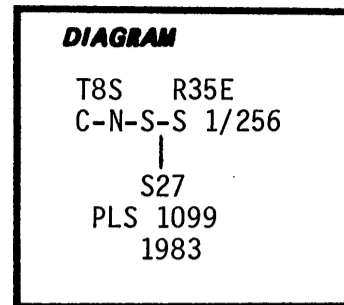

Description of corner evidence found:

None

Description of monument and accessories established to perpetuate the original location of this corner:

At the corner position determined by survey set a 2 1/2"x30" galv. iron pipe with brass cap 24" in the ground with raised mound of stone marked:

From which:

A Tamarack 8" dia. bears N 41°W 20.1 ft. marked CNSS 1/256 S 27 BT.

A Tamarack 20" dia. bears S 60°E 34.7 ft. marked CNSS 1/256 S27 BT.

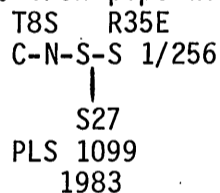

Attached brass washers stamped LS 1099 to BT blaze on both trees.

Corner location perpetuated in accordance with Umatilla N.F. survey contract No. 53-04R3-2-01275.

Post 5' + South with 54-2 & 54-9

Post 5' + West with 54-2

20°E Declination

Steel Tape

August 30, 1983

Witnesses: A. Ray Crapo
Greg Orton
Kyle McKinney

Corner falls in miners ditch running N-S 50' south of meadow.

Refer to Grant County Survey No. 828

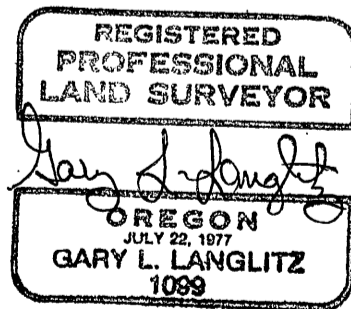

Office of SURVEYOR County of GRANT
 State of OREGON, I hereby certify that the within instrument was filed in this office
 for record on the 30 day of AUG, 1983
Robert R. Baggett by _____
 (COUNTY OFFICIAL) (DEPUTY)